

940

Serie 940 Stecker 6 / 8 / 9-polig, für Crimpkontakte Series 940 Plug 6 / 8 / 9-pin, crimp version

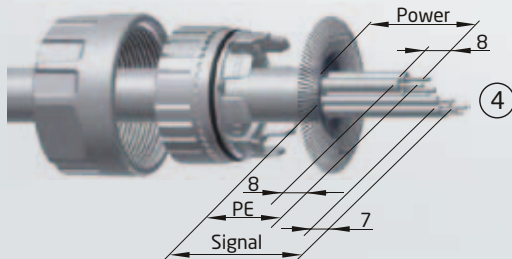

	Crimp Tool		Positioner		
	a[mm ²]	l[mm]	No.:	No.:	Colour
Signal	0,35 - 2,5	70	C0.201.00	C0.009.00	green
			digital crimp tool C0.236.00		tool settings: see crimp tool manual
PE	Contact Type				
		1,5 - 10 6 - 16			
	1,5 - 4,0	59	C0.008.00	C0.010.00	blue
	6 - 10	51	-	-	green
Power	16	51	C0.044.00+C0.233.00	C0.038.00	-----
	1,5 - 4,0	58	C0.008.00	C0.010.00	blue
	6 - 10	50	-	-	green
	16	50	C0.044.00+C0.233.00	C0.038.00	-----

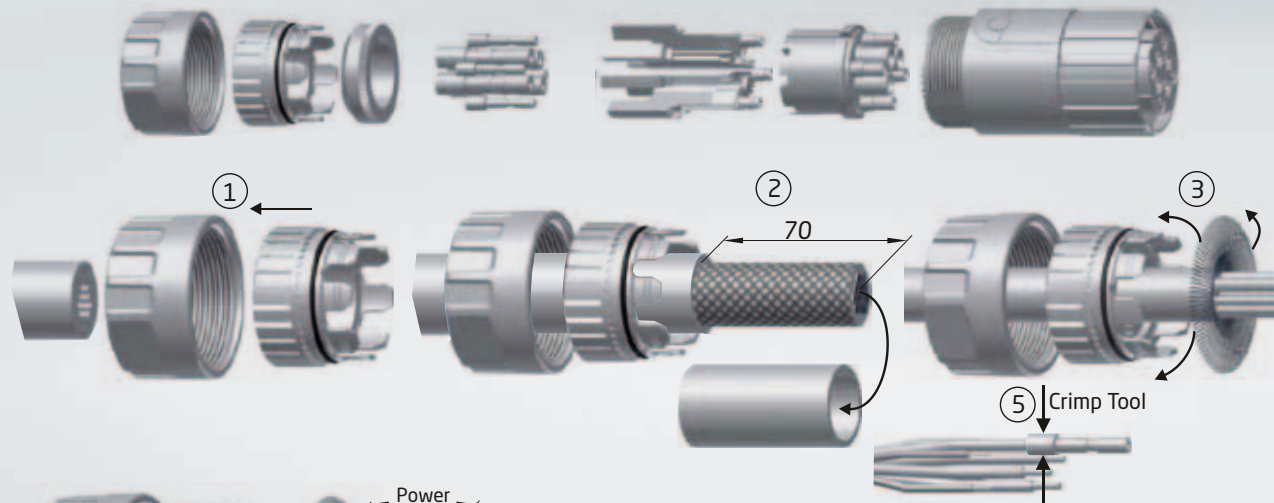
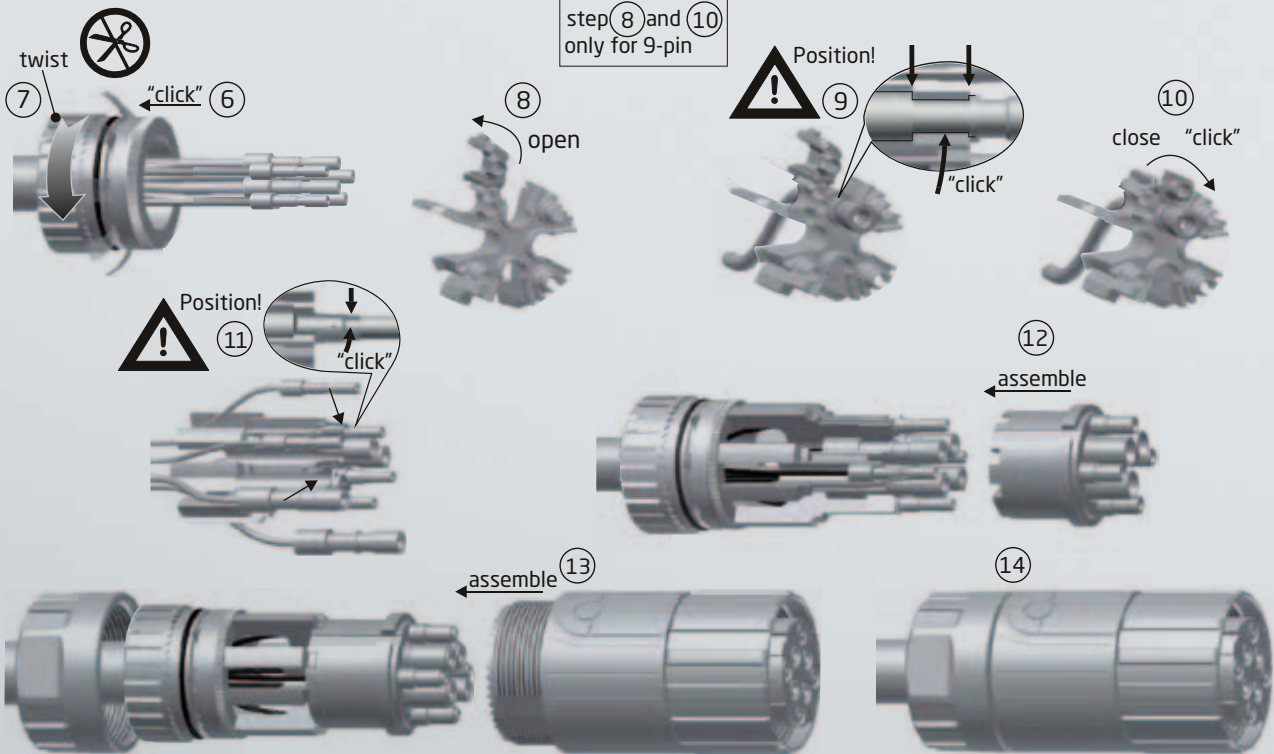

step 8 and 10
only for 9-pin

M	cable Ø 9-16mm: 27Nm
	cable Ø 16,5-25mm: 18Nm

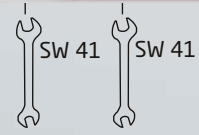

Serie 940 Kupplung 6 / 8 / 9-polig, für Crimpkontakte
Series 940 Extension 6 / 8 / 9-pin, crimp version

Step 1: Disassembly of the connector housing.

Step 2: Inserting the braided shield (70) into the housing.

Step 3: Inserting the crimp contacts into the housing.

Step 4: Identifying the contact types: Power (8), PE (8), and Signal (7).

Step 5: Crimping the wires using a crimp tool.

	Crimp Tool		Positioner	
	a[mm ²]	l[mm]	No.:	No.:
Signal	0,35 - 2,5	70	C0.201.00 digital crimp tool C0.236.00	C0.009.00 tool settings: see crimp tool manual
PE	Contact Type			
	1,5 - 4,0	59	C0.008.00	C0.010.00
	6 - 10	51	" "	" "
Power	1,5 - 4,0	58	C0.044.00+C0.233.00	C0.038.00
	6 - 10	50	" "	" "
	16	50	C0.044.00+C0.233.00	C0.038.00

Step 6: Twisting the wires and crimping them into the contacts.

Step 7: Closing the crimp contacts.

Step 8: Opening the crimp contacts.

Step 9: Positioning the crimp contacts correctly.

Step 10: Closing the crimp contacts.

Step 11: Final positioning and crimping.

Step 12: Assembling the connector housing.

Step 13: Final assembly of the connector.

Step 14: Tightening the connector housing with SW 41 wrench.

Torque Specifications:

M	cable	Ø	Torque
		9-16mm	27Nm
		16,5-25mm	18Nm

940

Serie 940 Winkelstecker, 6 / 8 / 9-polig, drehbar
 Series 940 Plug Angled, 6 / 8 / 9-pin, rotatable

1. Disassemble the connector housing into its components.

2. Insert the braided shield into the housing, ensuring a length of 125 mm.

3. Use a crimp tool (5) to crimp the shield onto the housing.

4. Strip the outer jacket (7) and separate the conductors: Power (8), PE (8), and Signal (7).

5. Crimp the conductors onto the appropriate pins using a crimp tool (5).

6. Twist the conductors and insert them into the housing, ensuring a "click" sound.

7. Twist the conductors (indicated by a scissors icon).

8. Insert the conductors into the housing.

9. Push the housing together to secure the connection.

10. Open the housing to check the connection.

11. Position the conductors correctly (indicated by a warning triangle and "Position!" text).

12. Close the housing, ensuring a "click" sound.

13. Position the conductors correctly (indicated by a warning triangle and "Position!" text).

14. Tighten the housing with a torque wrench (SW 41).

15. Apply a torque of M=3 Nm to the housing.

16. Tighten the housing with a torque wrench (SW 41).

17. The connector is rotatable (+/-180 degrees).

min. 1 mm and min. 0.75 mm dimensions are indicated for the housing.

	a[mm²]	L[mm]		Crimp Tool No.:	Positioner	
		1,5 - 10	6 - 16		No.:	Colour
Signal	0,35 - 2,5	125		C0.201.00 digital crimp tool C0.236.00	C0.009.00	green
Power	Contact Type					
	1,5 - 4,0	113	-----	C0.008.00	C0.010.00	blue
	6 - 10	105	113	-----	-----	green
	16	-----	105	C0.044.00+C0.233.00	C0.038.00	-----

M cable Ø 9-16mm: 27Nm
 cable Ø 16,5-25mm: 18Nm

Serie 940 Winkelkupplung speedtec / speedtec-ready, 6 / 8 / 9-polig, drehbar
Series 940 Extension Angled speedtec / speedtec-ready, 6 / 8 / 9-pin, rotatable

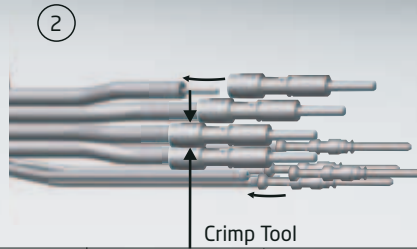
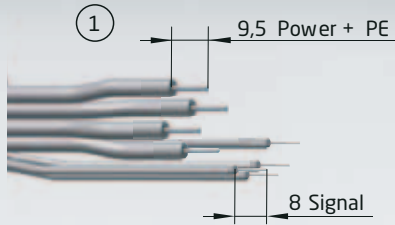

	Crimp Tool No.	Positioner	
		No.	Colour
Signal	C0.201.00	C0.009.00	green
PE/ Power	C0.008.00	C0.010.00	blue
	digital crimp tool C0.236.00	tool setting: see crimp tool manual	

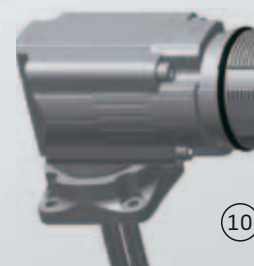
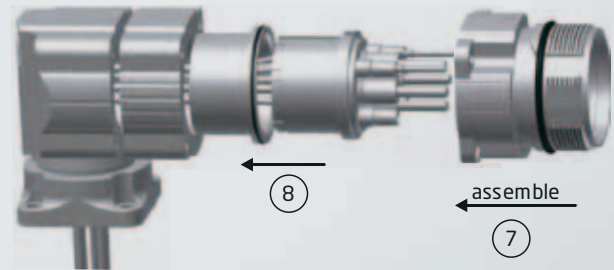
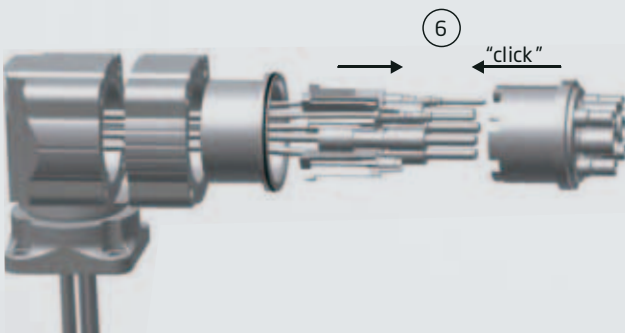
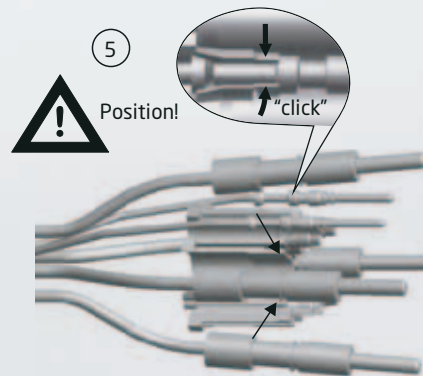
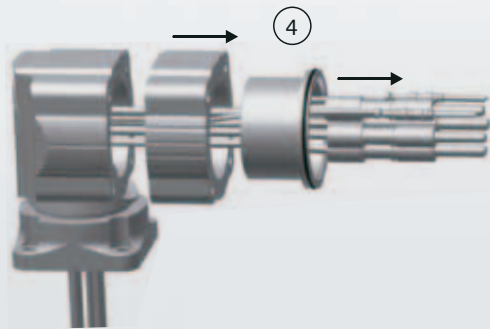
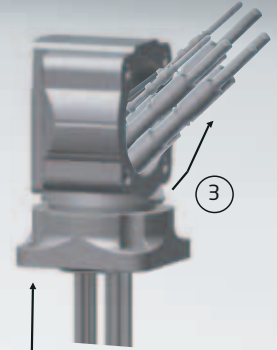

940

Serie 940 Durchführung, Größe 1,5, für Crimpkontakte
 Series 940 Bulkhead Connector, size 1.5, crimp version

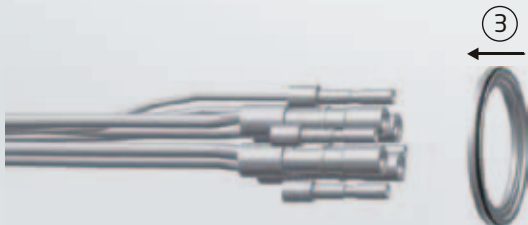
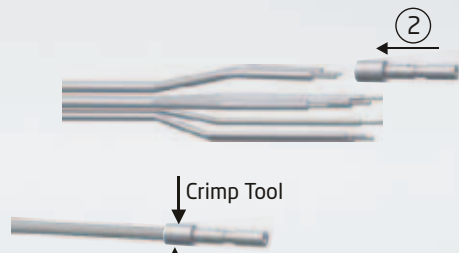
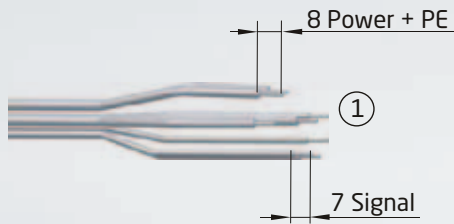
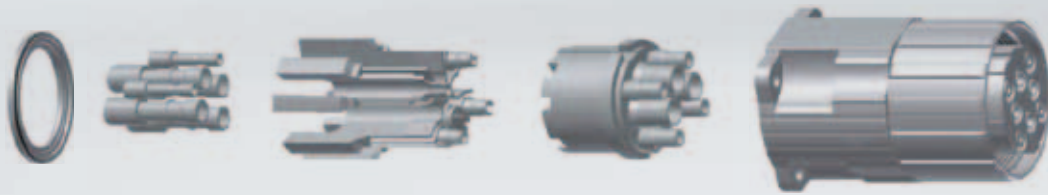

	a[mm ²]	1[mm]	Crimp Tool	Positioner	
			No.:	No.:	Colour
Signal	0,35 - 2,5	70	C0.201.00	C0.009.00	green
			digital crimp tool C0.236.00		tool settings: see crimp tool manual
PE	1,5 - 4,0	59	C0.008.00	C0.010.00	blue
	6 - 10	51/59	-	-	green
	16	51	C0.044.00+C0.233.00	C0.038.00	-----
Power	1,5 - 4,0	58	C0.008.00	C0.010.00	blue
	6 - 10	50	-	-	green
	16	50	C0.044.00+C0.233.00	C0.038.00	-----

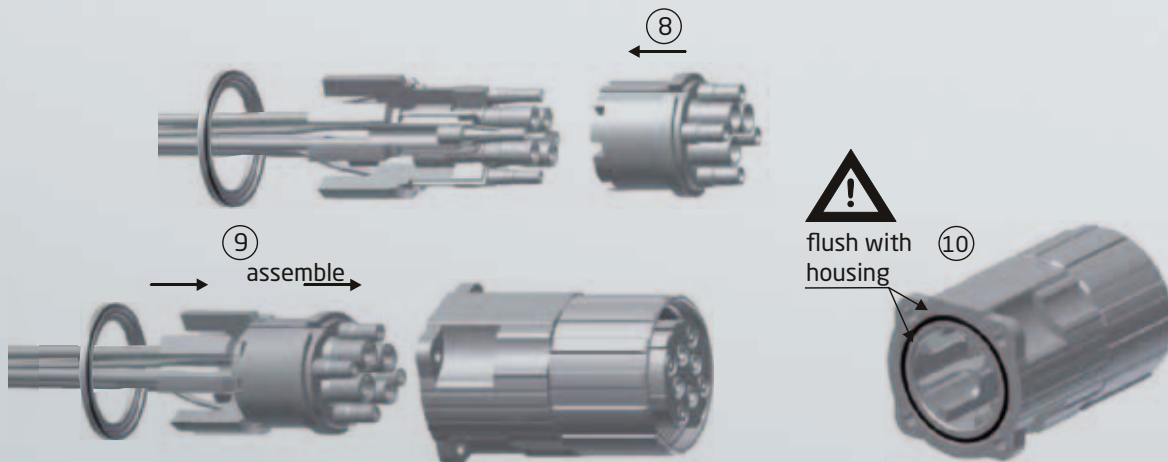
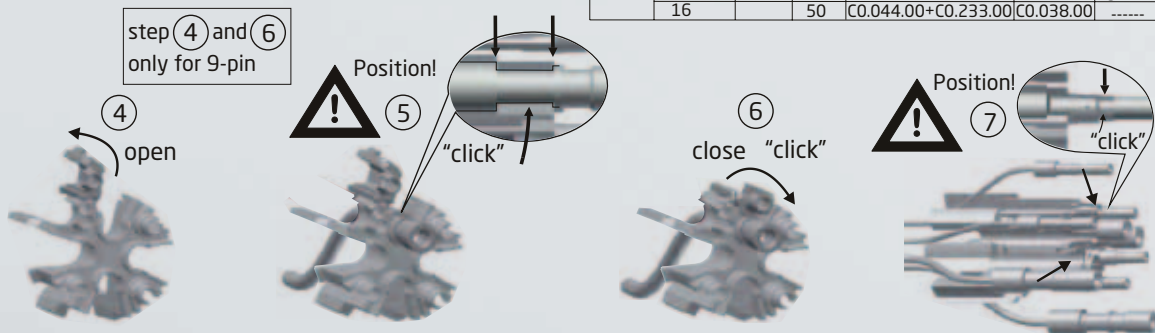

Serie 940 Einbaudose speedtec / speedtec-ready 6 / 8 / 9-polig
Series 940 Receptacle speedtec / speedtec-ready 6 / 8 / 9-pin

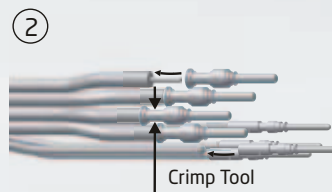
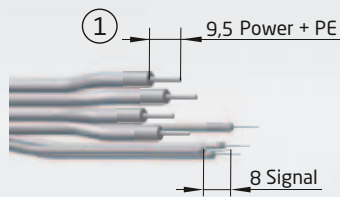

	Crimp Tool No.	Positioner	
		No.	Colour
Signal	C0.201.00	C0.009.00	green
PE/Power	C0.008.00	C0.010.00	blue
	digital crimp tool C0.236.00	tool setting: see crimp tool manual	

step ③ and ⑤ only for 9-pin

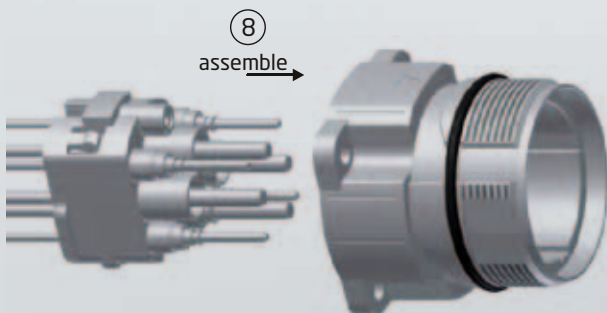
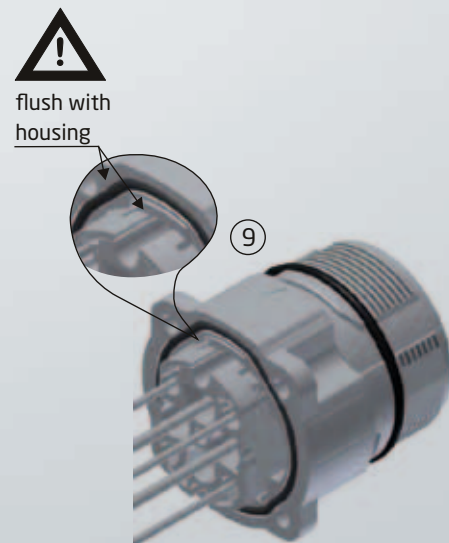
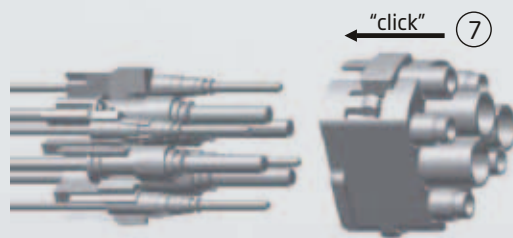
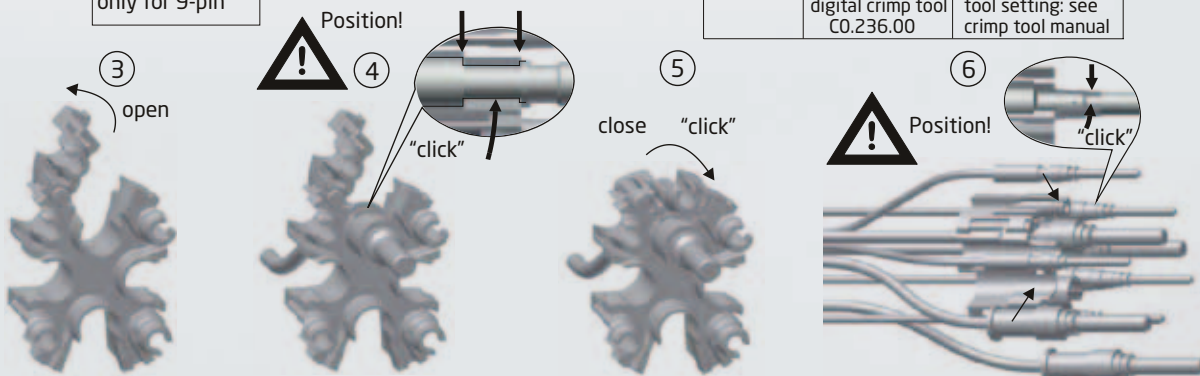

940

Serie 940 Winkeleinbaudose 6 / 8 / 9-polig, für Crimpkontakte, drehbar
 Series 940 Receptacle Angled 6 / 8 / 9-pin, crimp version, rotatable

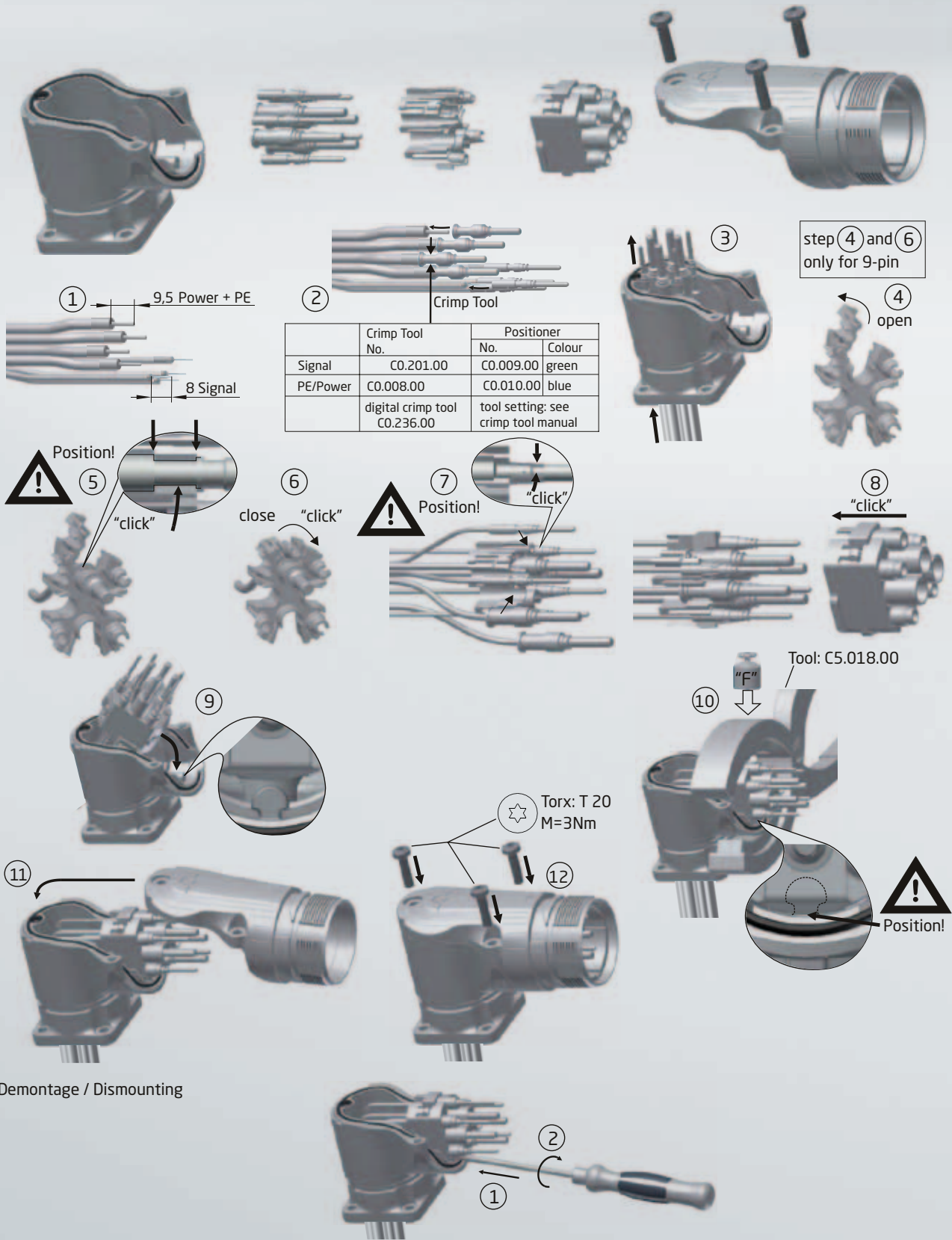

Demontage / Dismounting

Serie 940 Winkeleinbaudose 6 / 8 / 9-polig, 16 mm²
Series 940 Receptacle Angled 6 / 8 / 9-pin, 16 mm²

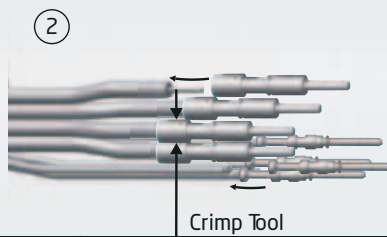
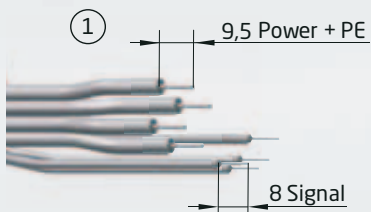
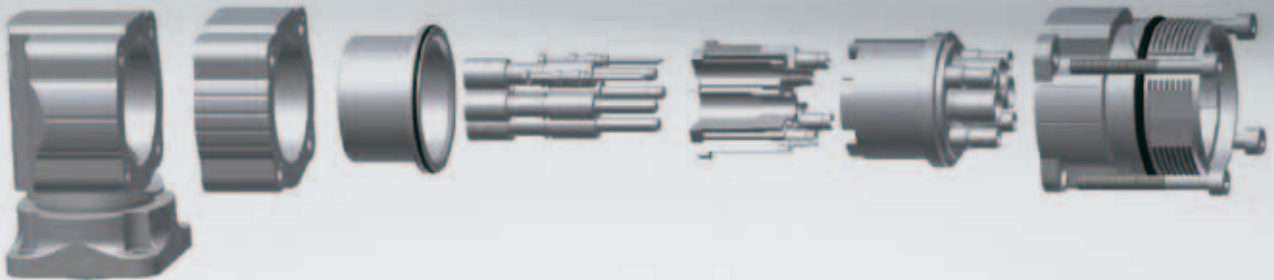

	Crimp Tool No.	Positioner	
Signal	C0.201.00	No.	Colour
PE/Power	C0.008.00	C0.009.00	green
		C0.010.00	blue
	digital crimp tool C 0.236.00	tool setting see crimp tool manual	

